

## STAINLESS STEEL BUCKETS

65 POUND

30165 - Short handle  
30166 - Long handle  
13½"W x 18½"H



75 POUND

30175 - Short handle  
30176 - Long handle  
13½"W x 20"H



55 POUND

30155 - Short handle  
30156 - Long handle  
12¾"W x 18½"H



30180 - Short handle  
30181 - Long handle  
14¾"W x 19½"H



80 POUND

35 POUND

30135 - Short handle  
30136 - Long handle  
11½"W x 13¾"H



90 POUND

30190 - Short handle  
30191 - Long handle  
14¾"W x 20½"H



- 304 STAINLESS STEEL BUCKETS
- PLEASE SPECIFY, VIA PART NUMBER, IF YOU NEED A SHORT OR LONG HANDLE WHEN ORDERING.
- SEE PAGES 74 & 75 FOR LIDS.

### MISCELLANEOUS BUCKET PARTS

- 30151 - Short handle only for regular stainless bucket - 8"
- 30152 - Long handle only for regular stainless bucket - 9"
- 30154 - Trimming charge to make bucket fit WF lid
- 30157 - Bucket tilt handle for bottom rim
- 30159 - Stainless hanger to hang up bucket
- 30158 - Ear bracket, for milk bucket handle (weld on)

30159



### STAINLESS STEEL MILK CARRYING CANS



WITH LID

- 30120 - 2 quart
- 30122 - 5 quart
- 30125 - 10 quart

### HEAVY DUTY STAINLESS BUCKETS AND HANDLES

- 40155 - 55 lb with short handle
- 40156 - 55 lb with long handle
- 40165 - 65 lb with short handle
- 40166 - 65 lb with long handle
- 40175 - 75 lb with short handle
- 40176 - 75 lb with long handle
- 40180 - 80 lb with short handle
- 40181 - 80 lb with long handle
- 40182 - Short handle
- 40183 - Long handle

### 68LB PLASTIC BUCKETS AND HANDLES



No Warranty On Plastic Buckets

- 30300 - Bucket with short handle
- 30304 - Bucket with long handle

#### HANDLES ONLY

- 30301 - Short handle
- 30302 - Long handle

### STAINLESS STEEL MILK CANS

These cans are made of 18 gauge stainless and are for holding milk only and are not designed to have vacuum applied. Lid and gasket are included. Lids have a silicone seal. The lid attaches using 2 "snap down" latches directly across from each other. These milk cans are not stackable.

- 30194 - 70 lb can with cover, 19½" x 13"
- 30192 - 90 lb can with cover, 24" x 13"
- 30197 - 100 lb can with cover, 25" x 14"
- 30195 - Silicone gasket for milk can lid





# BUCKETS ~ LIDS ~ PARTS

See page 21 for pulsator parts

Bucket units come with a 14300 Style Claw. If you need the 10867 claw you will need to order part 30075 in addition to the unit you are ordering. There is no additional charge.

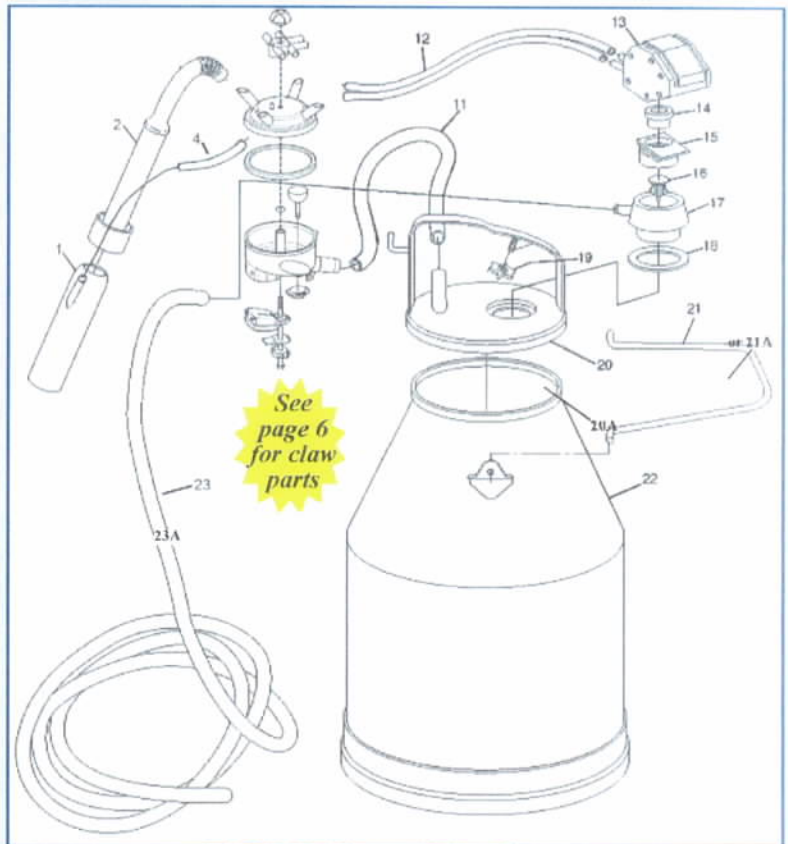

See page 6 for claw parts

## COMPLETE BUCKET UNITS WITH D#95 PULSATION AND 14300 KLEEN-FLO CLAW

- 30005 - 35 lb S/S Bucket
- 30010 - 55 lb S/S Bucket
- 30015 - 65 lb S/S Bucket
- 30020 - 75 lb S/S Bucket
- 30025 - 80 lb S/S Bucket
- 30030 - 90 lb S/S Bucket
- 30045 - 68 lb Plastic Bucket
- 30002 - Complete unit LESS bucket

See page 86 & 87 for portable vacuum pumps

## COMPLETE BUCKET UNITS WITH OTHER PULSATION AND 14300 KLEEN-FLO CLAW

- 30100 - 80 lb S/S Bucket with HP102 pulsator
- 30110 - 80 lb S/S Bucket with Vacupuls pulsator

1	10010	Rolled edge shell	16	23027	Check valve for chamber
2	25003	KF-01 inflation	17	23056	Chamber housing
4	25150	9" air tube	18	23028	Chamber gasket
5	14300	New style claw with valve (see page 6 for claw parts)	19	33004	Plastic lid nut
11	25145	32" x 5/8" clear milk hose	19	33002	Stainless lid nut
12	25143	37" x 9/32" twin rubber hose	20	33000	Stainless lid
13	20360	D#95 pulsator assembly (see page 21 for pulsator parts)	20A	25195	Lid gasket
14-18	23031	Complete adaptor for D#95	21	30151	Stainless handle, short
14	23029	Chamber seal	21A	30152	Stainless handle, long
15	23040	Chamber slide	22	30165	65 lb bucket
			23	25141	6' x 1/2" rubber vacuum hose
			23A	25140	12' x 1/2" clear vacuum hose